

EVO24-P



Touring Line-Array System

FEATURES

- Premium European High Efficiency custom-IDEA Transducers
- Proprietary High-Q 8-slot dual-driver waveguide assembly
- Multi-enclosure cabinet design
- Rugged and durable 15 mm Birch Plywood construction and finish
- 1.5 mm Aquaforce coated steel grille with internal protective foam
- Integrated Precision rigging system with 10 angulation points
- Integrated lateral bars for transport and setup
- Durable Aquarforce paint coating process



APPLICATIONS

- Main system for Touring and Rental Companies
- Very High SPL installed sound reinforcement

OVERVIEW

EVO24-P is a passive large-format touring line array system specifically designed for professional sound reinforcement in big events, large venues or open spaces for audiences from 5000 to 50000, in productions or events operated by rental companies or pro-audio contractors.

EVO24-P is a 4-Way line-array element that features dual-12" Neodymium LF woofers, 4 x 6.5" MF woofers in two sealed chambers and 2 x 3" Neodymium compression drivers coupled to a proprietary-design waveguide assembly.



TECHNICAL DRAWINGS

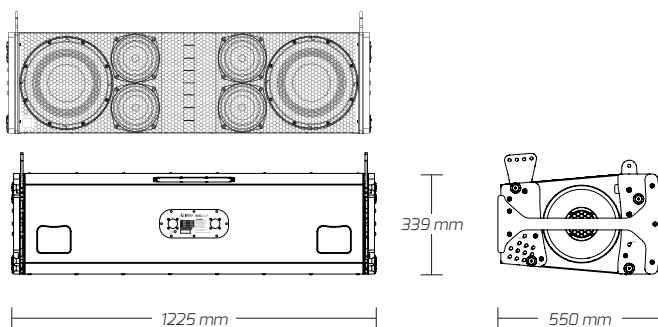

TECHNICAL DATA

Enclosure design	10° Trapezoidal cabinet
LF Transducers	2 x 12" (4" voice coil) Neodymium woofers
MF Transducers	4 x 6.5" (2.5" voice coil)
HF Transducers	2 x 3" Neodymium compression drivers
RMS Power Handling	1300 + 1300 + 800 + 140 W
Nominal Impedance	8 + 8 + 16 + 16 Ω
SPL (Continuous/Peak)	135/141 dB SPL
Frequency Range (-10 dB)	47 - 23000 Hz
Frequency Range (-3 dB)	76 - 20000 Hz
Coverage	90° Horizontal
Connectors	2 x Neutrik® SpeakON NL-4
+/- 1	Input
+/- 2	Link
Cabinet Construction	15/18 mm Plywood with Aquaforce finish
Rigging Hardware	High-resistance, coated steel integrated 4-point rigging hardware 10 angulation points (0°-10° internal splay angles in 1° steps)
Dimensions (WxHxD)	1225 x 339 x 550 mm (48,2 x 13,3 x 21,7 inch)
Weight	84 kg (185,1 lbs)
Accessories	Rigging frame (RF-600) Transport cart for 3 units (CART_EVO24) Cover for 3 units (COVER_EVO24)

* IEC filtered pink noise with a 6dB crest factor, 2 hours.

ACOUSTICAL MEASUREMENTS

FREQUENCY RESPONSE

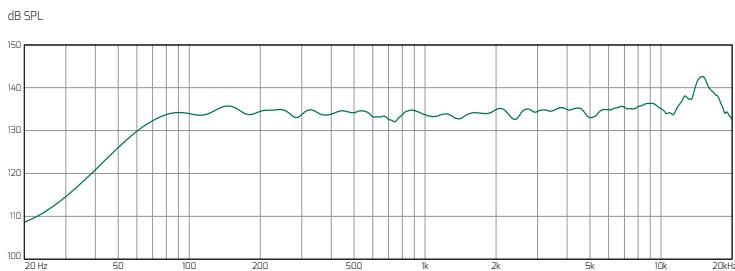

* The above graph shows the frequency response for a 1-watt swept sine signal in an anechoic environment (4π), measured at 3 m and scaled down at 1 m.

In order to provide more precise information for acoustical analysis, a 1/12 octave smoothing has been applied.

IMPEDANCE

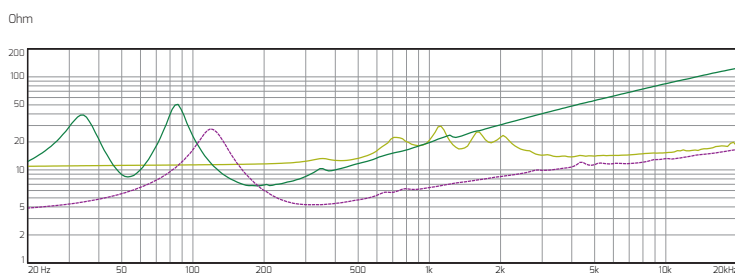

HORIZONTAL 1/3 OCTAVE POLARS

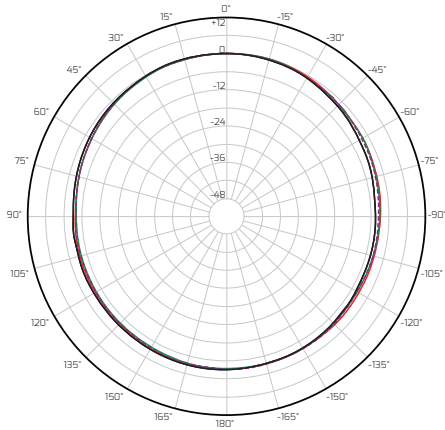

- 80 Hz
- 100 Hz
- - - 125 Hz
- 160 Hz

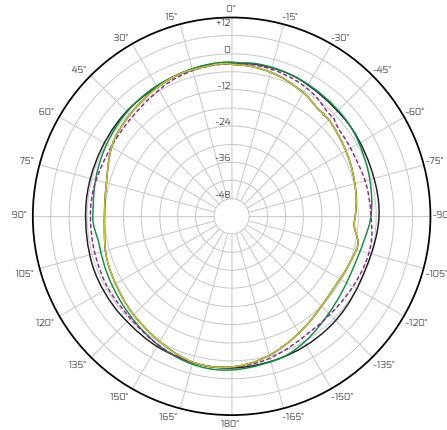

- 200 Hz
- 250 Hz
- - - 315 Hz
- 400 Hz

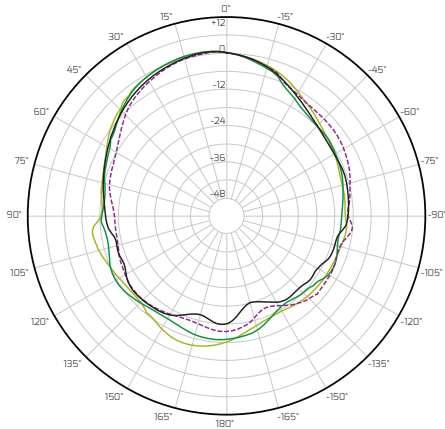

- 500 Hz
- 630 Hz
- - - 800 Hz
- 1000 Hz

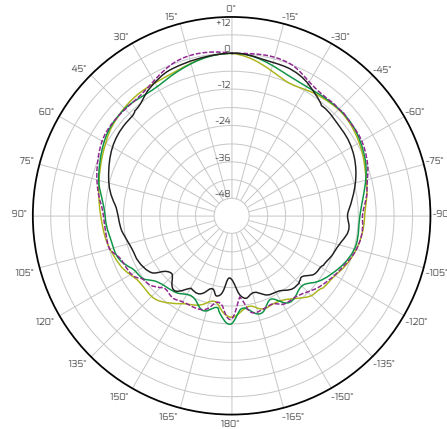

- 1.25 kHz
- 1.6 kHz
- - - 2 kHz
- 2.5 kHz

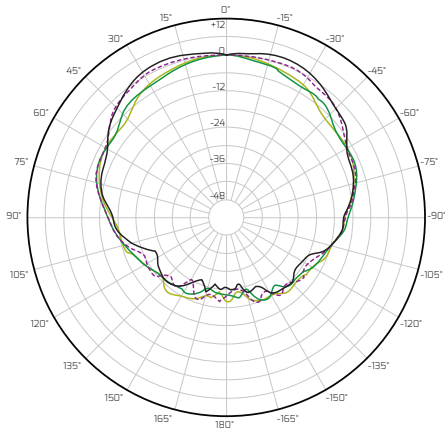

- 3.15 kHz
- 4 kHz
- - - 5 kHz
- 6.3 kHz

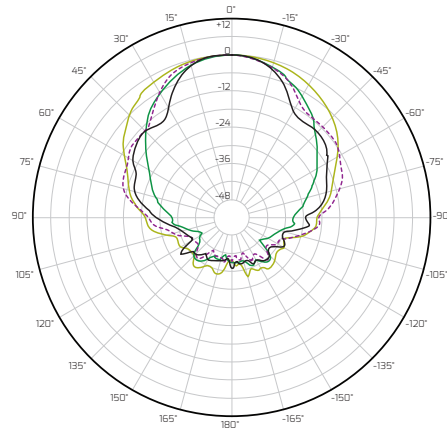

- 8 kHz
- 10 kHz
- - - 12.5 kHz
- 16 kHz

VERTICAL 1/3 OCTAVE POLARS

